

# Simply Better, From the Ground Up



Introducing the Sonesta Simply Suites®  
New Construction Prototype





# SONESTA Simply Suites

## Innovative Design & Efficient Site Utilization

Sonesta Simply Suites introduces its new design prototype, created to optimize functionality and market adaptability. Designed on a conceptual 1.70-acre site, the prototype stands out as an efficient and competitive option in the extended-stay market. The Sonesta Simply Suites prototype is designed to maximize every square foot for guest comfort and promote operational efficiency.

### TWO FLEXIBLE PROTOTYPICAL CONFIGURATIONS

To cater to diverse market needs, the Sonesta Simply Suites prototype offers two configurations:

#### 4-Story Model – 122 Keys

- 57 Queen Studios
- 34 King Studios
- 31 Double Queen Studios

#### 3-Story Model – 89 Keys

- 42 Queen Studios
- 25 King Studios
- 22 Double Queen Studios

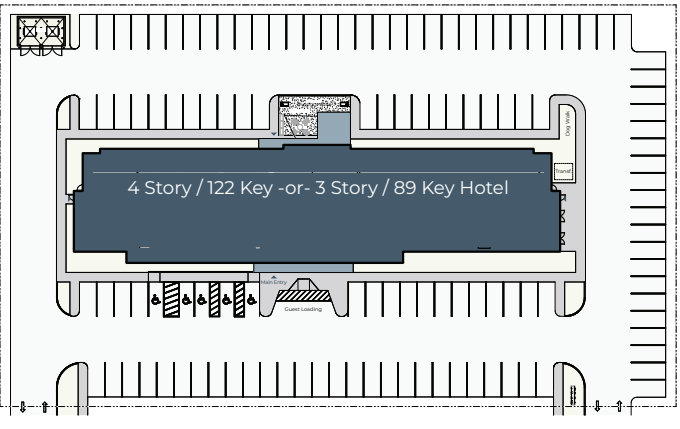

### GUESTROOM TYPES

**QUEEN (284 SF) & KING STUDIOS (297 SF)**  
Designed in tandem with one another, the King Studio offers an upgrade opportunity and is aimed to offer broader appeal to leisure & non-contract business travelers, with minimal increase in square footage.

#### Key Features:

- Bed with Adjacent Integral Power & Underbed Storage (Sized for Luggage)
- Dresser & Open Closet
- Large Work Desk & Chair with Integral Power & Task Lamp
- Corner Sette Seating / Dining Area with Movable Table
- 50" Smart HDTV
- In-Suite Simple Kitchen
- Bathroom w/ Wall to Wall Vanity, Backlit Mirror & Walk-In Shower

**DOUBLE QUEEN STUDIO (375 SF)**  
Designed to accommodate families, as well as target business contracts that require Double Occupancy.

#### Key Features:

- Two Beds w/ Adjacent Integral Power & Underbed Storage (Sized for Luggage)
- Dresser & Open Double Closets
- Large Work Desk & Chair with Integral Power & Task Lamp
- Corner Sette Seating / Dining Area with Movable Table & Ottoman
- 50" Smart HDTV
- In-Suite Simple Kitchen
- Bathroom w/ Wall to Wall Vanity, Backlit Mirror & Walk-In Shower

**KING SUITE (375 SF)**  
Designed to provide further upgrade opportunities, and provide a little more space for guests on longer stays. Intended to be an Optional Room Type that can replace Double Queen Bays in desired markets and serve as an alternative to a conventional One Bedroom Suite.

#### Key Features:

- Bed w/ Adjacent Integral Power & Underbed Storage (Sized for Luggage)
- Dresser & Open Closet
- Large Work Desk & Chair with Integral Power & Task Lamp
- Living Area w/ Queen Sleeper Sofa, C-Table & Coffee Table
- 50" Smart HDTV
- Dining Table w/ Two Dining Chairs
- In-Suite Simple Kitchen
- Bathroom w/ Wall to Wall Vanity, Backlit Mirror & Walk-In Shower







# PUBLIC AREAS

## ARRIVAL & ENTRY

An Entry Canopy enhances the arrival experience with a welcoming appearance, identifiable point of entry, and warm wood cladding.

### Key Features:

- Drop-Off Curb & Landscaped Arrival
- Ride-Share Waiting Bench
- Luggage Cart Storage
- Food Delivery Drop Station

## RECEPTION & LOBBY

Larger, but still efficient, the Reception & Lobby serve as not just a welcome, but also a hub for circulating through a Simply Suites. The Market is front & center for guest appeal.

### Key Features:

- Reception Desk with Two Stations
- 24/7 Grab & Go Market
- Community Table & Lounge Chairs
- Pop of Inspiration

## MUD ROOM

A secondary entrance to the hotel – and connection between the Lobby, Outdoor Area, Fitness & Laundry – the Mud Room consolidates many of the items that guests need into one simple location.

### Key Features:

- Kitchen On Demand
- Ice & Filtered Water Dispenser
- Guest-Use Wireless Printer
- Rentable Storage Lockers

## FITNESS CENTER

### Key Features:

- Cardio Zone w/ Integral TVs
- Strength Zone with Framed Mirror
- Towel & Water Station

## GUEST LAUNDRY

### Key Features:

- Commercial Washers & Dryers
- Folder, Hanging, & Drying Station
- Table & Chairs

## MEETING ROOM

(Optional, Replaces 1 Queen Studio Key)

### Key Features:

- Board Room Table & Chairs
- Refreshment Center
- Screen with Presentation Capabilities

## OUTDOOR AREA

Integrated into the architecture of the building, an overhead canopy defines and shelters the Outdoor Area and identifies the secondary entrance to the hotel.

### Key Features:

- Covered BBQ & Dining Area
- String Lit Lounge Seating Area
- Outdoor Games
- Guest-Use Raised Planters

**Want to learn more? Contact us today  
to explore the future of Sonesta Simply Suites.**

Email us at [development@sonesta.com](mailto:development@sonesta.com) • Learn more at [franchise.sonesta.com](http://franchise.sonesta.com)

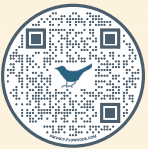

Any permitted use of design prototype requires consultation with architecture, design and construction professionals. This is not an offering. No offer or sale of a franchise will be made except by a Franchise Disclosure Document in compliance with applicable law. Franchises are offered in the U.S. through Sonesta RL Hotels Franchising Inc., and in Canada through Sonesta RL Hotels Canada Franchising Inc. MN#F-10006. 400 Centre Street, Newton, Massachusetts, 02458. © 2025 Sonesta International Hotels Corporation